

**NEXGEN SANITARYWARE LLP.**

MFG. Sanitarywares

8-A, N.H. Nr. Dadashree Nagar,  
Ravaparnadi Road, Morbi - 363 642, Gujarat, India.

Call  
+91 99252 39077, +91 95124 77000

Mail  
info@nexgenbathware.com

Web  
www.nexgenbathware.com

© Mumukshu Graphics Pvt. Ltd. 2020

PREMIUM SANITARYWARE

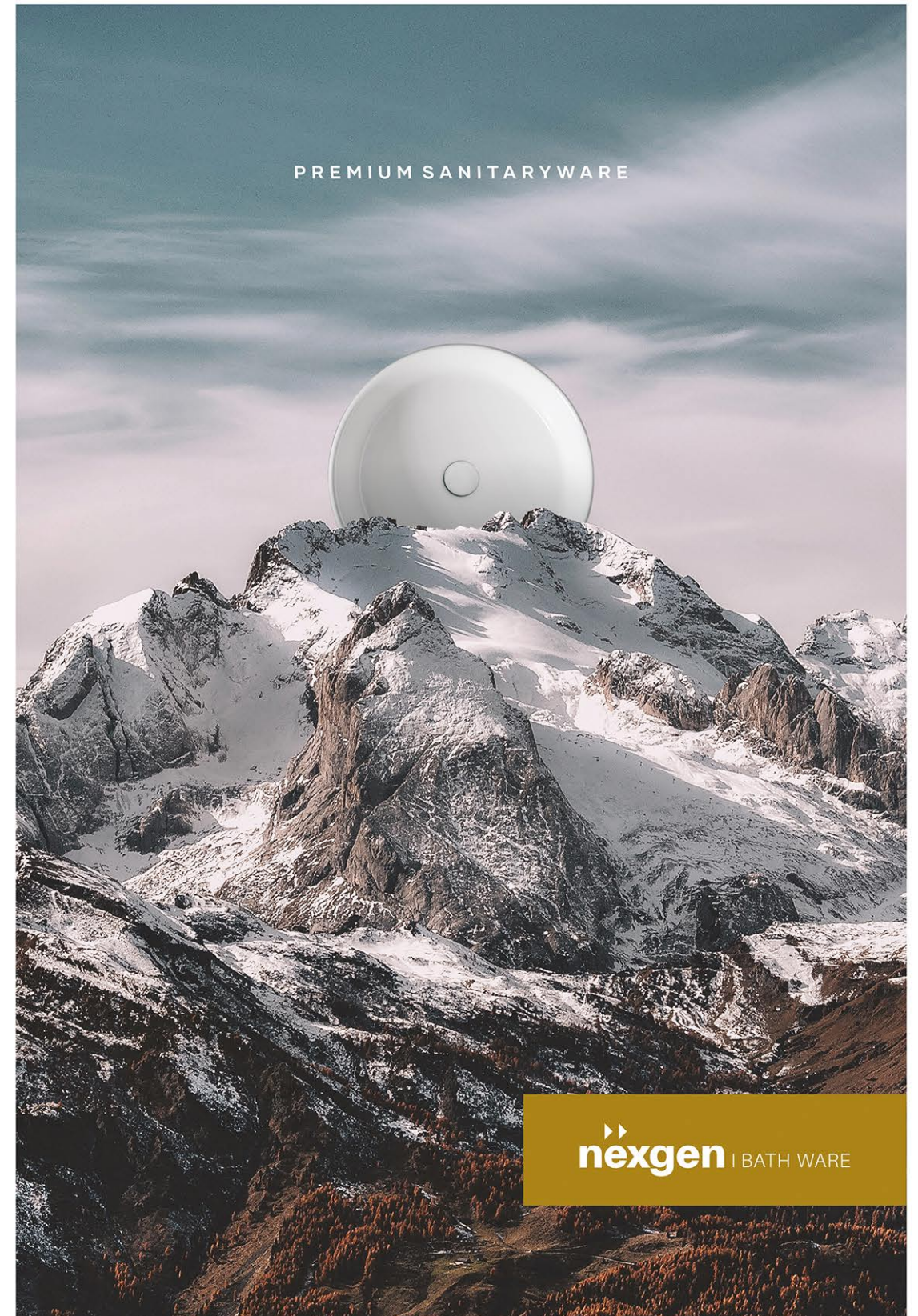

**nexgen** | BATH WARE



# Premium Innovation for Next Generation

Nexgen Sanitarywares has emerged as one of the eminent manufacturers and exporters in the industry offering a wide and extensive range of durable sanitarywares in different products like Wash Basin Pedestal, One Piece Closet, Table Top, Wall Hung, Urinal etc.

Our entire product range is highly in demand because of its impeccable quality and excellent services.

Nexgen Sanitaryware is a modernized international enterprise integrated with R&D, manufacturing, sales and Service. We have a complete sales and services.

We have a complete sales strategy and efficient sales team, applying brand strategy, setting up enterprise image and being an advocate and pioneer in the field of world class sanitary ware.

 **nexgen** | BATH WARE



PREMIUM  
COLLECTION



## ***When it's about to Art, Handcrafted luxury***

When it's about to art and culture, when it's about to hand made and technology, when it's about to dream and reality, We bridge quality with expectation that give you new and unique bath space where it put you in a day dream.

A unique brand with a strong identity and years of innovation and excellence in manufacturing. All our products are manufactured in our workshops in Gujarat, with high quality standards. Provides a smart & Sustainable design combined with full quality concept. Inspiring a contemporary architecture and designers worldwide. The company present innovation with its magnificent array of sanitary ware products.



## ***Connecting the world to the next generation***

Driving its exports growth constantly and expanding its reach to different territories across the continents. Presently, the company exports to more countries worldwide, which is a testimony to its excellent reputation in the industry.

Nexgen exports are stretched across an ever increasing network of more than 50+ countries.

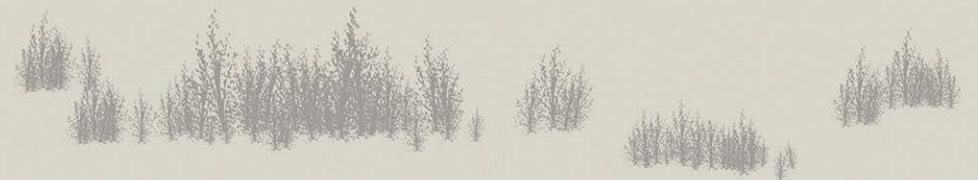

## THE PRODUCT ATTRIBUTES



Each product radiates glossiness and whiteness



Use of finest raw materials - Purified, tested and certified by R&D



Use of advanced German technology with fully computerized controlled Shuttled Kiin



Use of eco-friendly natural gas residues for better shine and luster



Production process according to ISI, ISO European standard



High-tempered firing with hygiene-friendly production process



Water-saving flushing system with 3/6-litre knobs



Soft closing seat cover



# INDEX

TRUST OF NEXT  
GENERATION

## COLLECTION

01 ONE PIECE

07 WALL HUNG CLOSET

13 TABLE TOP BASIN

25 WALL HUNG BASIN

31 UNDER / TOP COUNTER

33 HALF WALL HUNG BASIN

35 FULL BASIN

37 BASIN WITH PEDESTAL

44 INDO WESTERN

46 ANGLO

47 ORISSA PAN

48 CITY PAN

49 URINAL



# ONE PIECE CLOSET



705

ONE PIECE CLOSET  
WASH DOWN  
S-TRAP (100mm / 225mm)  
P-TRAP (225mm)  
L650, W350, H720mm

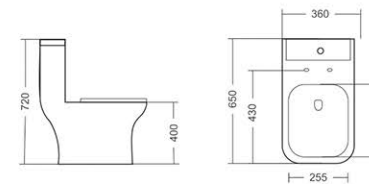

ONE PIECE CLOSET



717

ONE PIECE CLOSET  
WASH DOWN  
S-TRAP (225mm)  
P-TRAP (225mm)  
L700, W370, H730mm

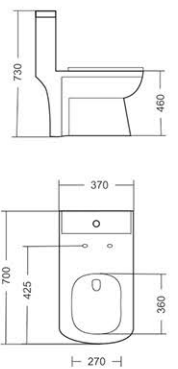

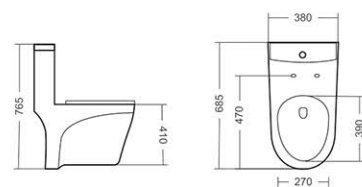

718

ONE PIECE CLOSET  
S-TRAP (300mm / 406mm)  
TORNADO FLUSHING

L685, W380, H765mm

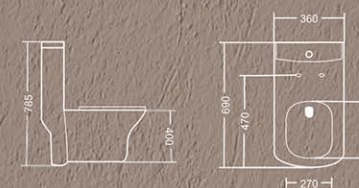

779

ONE PIECE CLOSET  
S-TRAP (225mm / 300mm)  
TORNADO FLUSHING

L690, W360, H785mm







754

ONE PIECE CLOSET  
WASH DOWN  
S-TRAP (225mm)  
P-TRAP (225mm)

L670, W350, H725mm

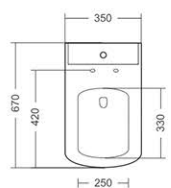

761

ONE PIECE CLOSET  
S-TRAP (225mm / 300mm)

L650, W345, H680mm

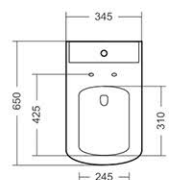
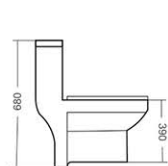

772

ONE PIECE CLOSET  
S-TRAP (300mm)  
TORNADO FLUSHING

L670, W360, H750mm

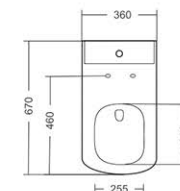
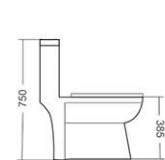

Rimless



Tornado  
Flushing



Symphonic  
Systems



734

ONE PIECE CLOSET  
S-TRAP (225mm)  
TORNADO FLUSHING

L660, W370, H740mm

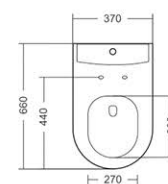
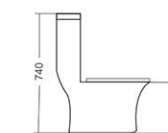



# WALL HUNG CLOSET

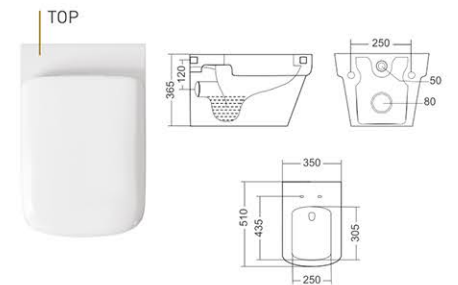

**703**  
WALL HUNG CLOSET  
WASH DOWN  
L510, W350, H365mm



**706**

WALL HUNG CLOSET  
WASH DOWN  
L510, W370, H360mm

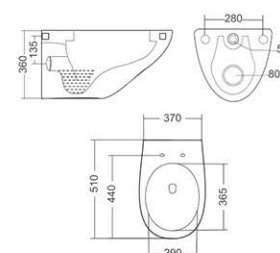

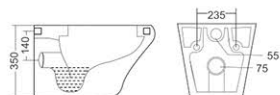

728

WALL HUNG CLOSET  
WASH DOWN

L530, W355, H350mm

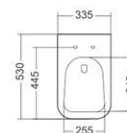

755

WALL HUNG CLOSET  
RIMLESS

L530, W335, H355mm

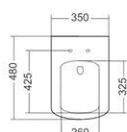

756

WALL HUNG CLOSET  
RIMLESS

L480, W350, H330mm



757

WALL HUNG CLOSET  
WASH DOWN

L490, W360, H365mm

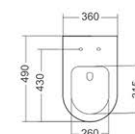
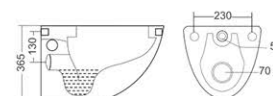

758

FLOOR STANDING CLOSET  
WASH DOWN  
S-TRAP  
P-TRAP

L550, W340, H395mm

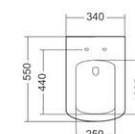
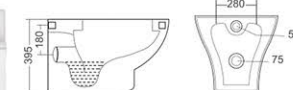



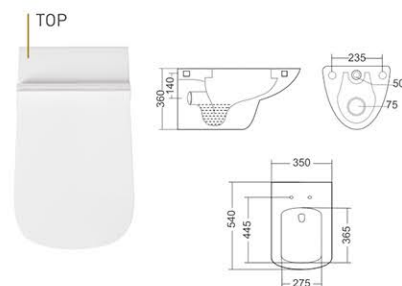

**759**

WALL HUNG CLOSET  
RIMLESS

L540, W350, H360mm



**760**

WALL HUNG CLOSET  
RIMLESS

L505, W360, H350mm

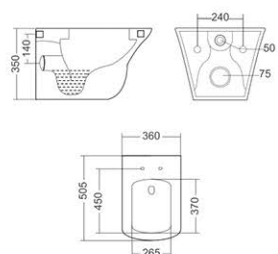

TOP



**776**

WALL HUNG CLOSET  
WASH DOWN

L475, W350, H330mm

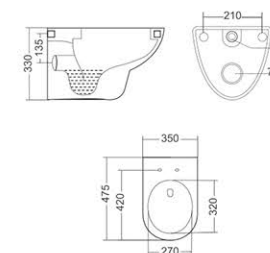

WALL HUNG CLOSET

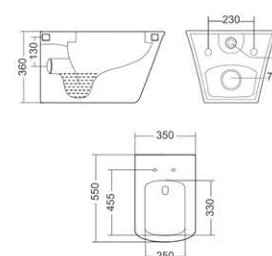

TOP



**791**

WALL HUNG CLOSET

L550, W350, H360mm



TOP



**800**

FLOOR MOUNT

L505, W360, H400mm

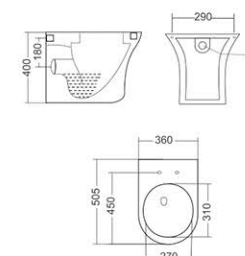
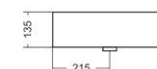
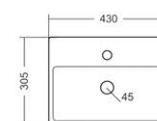

TABLE TOP



TOP

701

TABLE TOP BASIN  
WALL HUNG BASIN

L430, W305, H135mm



TOP

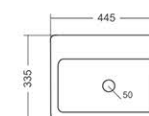

710

TABLE TOP BASIN  
WALL HUNG BASIN

L445, W335, H125mm

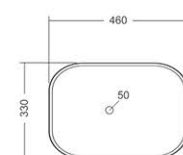

TOP

712

TABLE TOP BASIN

L460, W330, H140mm



WALL HUNG / TABLE TOP BASIN





714

TABLE TOP BASIN  
L320, W320, H110mm

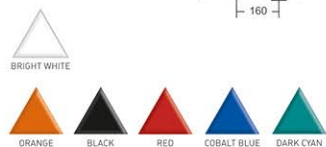
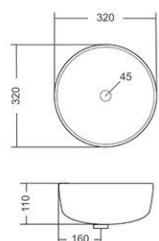

719

TABLE TOP BASIN  
L350, W350, H140mm



Ambient Design  
With Distinctive Strong  
Character And Style

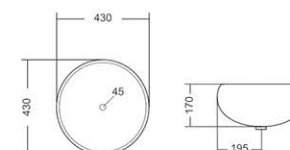

724

TABLE TOP BASIN  
L430, W430, H170mm





726

TABLE TOP BASIN  
WALL HUNG BASIN  
L430, W300, H130mm

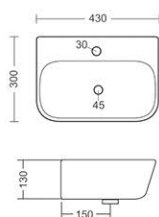

727

TABLE TOP BASIN  
L380, W380, H120mm

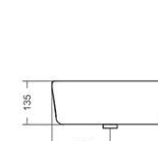
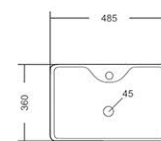
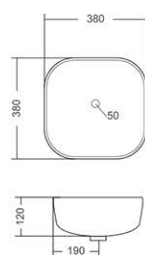

737

TABLE TOP BASIN  
L485, W360, H135mm



Various Styles Blend And Mix Together  
In The **Luxury Art**



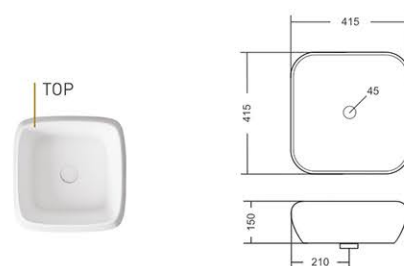

740

TABLE TOP BASIN  
L415, W415, H150mm



768

TABLE TOP BASIN  
L740, W400, H140mm

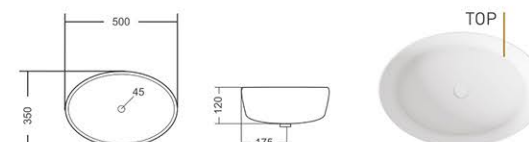
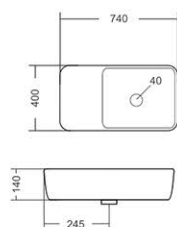

745

TABLE TOP BASIN  
L500, W350, H120mm

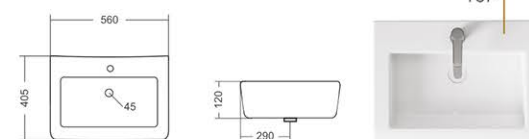

746

TABLE TOP BASIN  
WALL HUNG BASIN  
L560, W405, H120mm

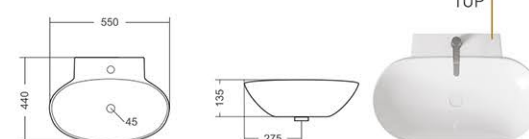

744

TABLE TOP BASIN  
WALL HUNG BASIN  
L550, W440, H135mm



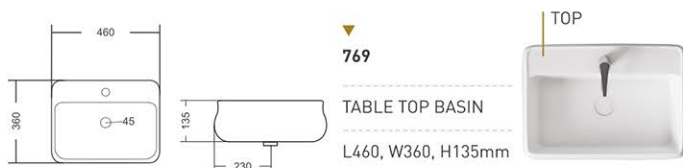

**770**

TABLE TOP BASIN

L460, W360, H170mm

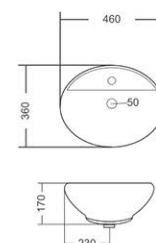

**771**

COUNTER BASIN

L520, W420, H160mm

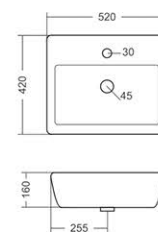



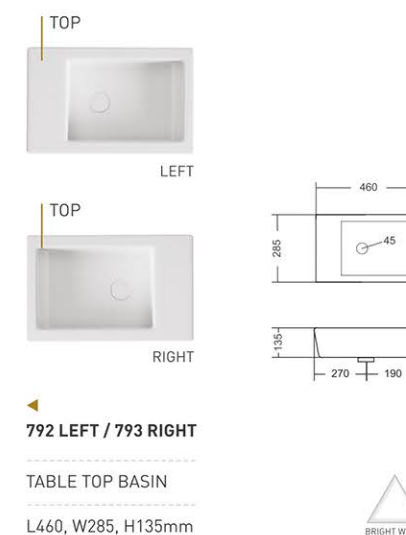

**794 LEFT / 795 RIGHT**  
TABLE TOP BASIN  
L450, W275, H150mm

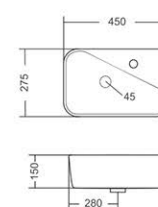

## WALL HUNG BASIN



707

WALL HUNG CORNER BASIN

L350, W350, H140mm

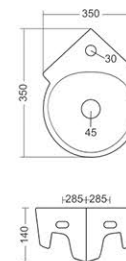

WALL HUNG BASIN



752

WALL HUNG BASIN /  
TABLE TOP BASIN

L455, W360, H140mm

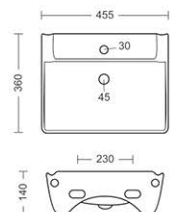



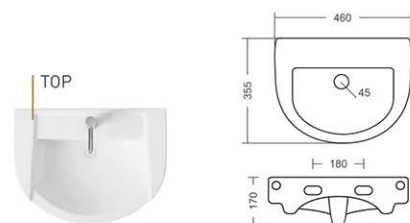

713

WALL HUNG BASIN

L460, W355, H170mm



722

WALL HUNG BASIN

L460, W360, H160mm

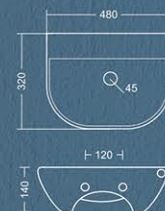
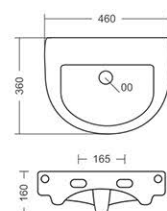

723

WALL HUNG BASIN

L480, W320, H140mm





738

WALL HUNG BASIN  
L460, W305, H170mm

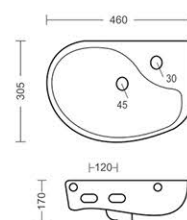

751

WALL HUNG BASIN / CABINET  
L425, W355, H175mm

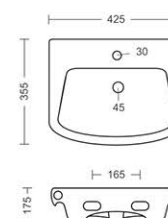
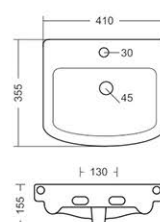

TABLE TOP / WALL HUNG BASIN



750

WALL HUNG BASIN  
L410, W355, H155mm



790

WALL HUNG BASIN  
L460, W310, H180mm

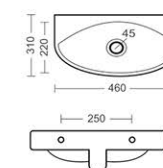





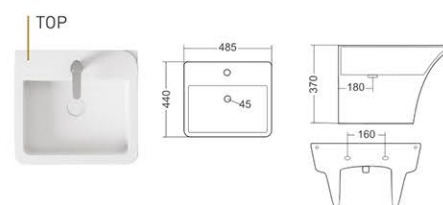

**704**  
HALF WALL HUNG BASIN  
L485, W440, H370mm



**720**  
HALF WALL HUNG BASIN  
L375, W355, H260mm

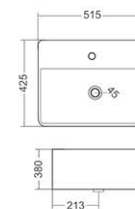
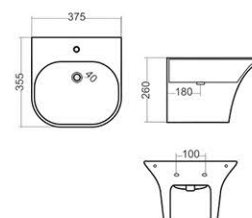

**785**  
HALF WALL HUNG BASIN  
L515, W425, H380mm

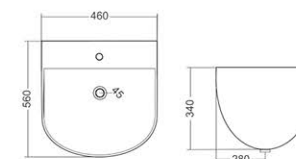

**767**  
HALF WALL HUNG BASIN  
L560, W460, H340mm





739

FULL BASIN

L460, W460, H800mm

TOP

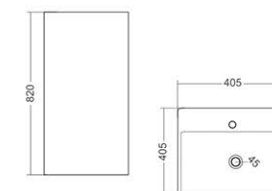
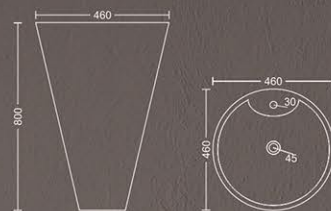

733

FULL BASIN

L405, W405, H820mm



FULL BASIN



TOP

736

FULL BASIN

L430, W430, H850mm

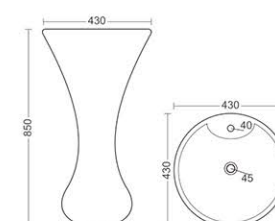

# BASIN WITH PEDESTAL



**BASIN - 780**  
L570, W460, H275mm

**PED - 730**  
L170, W225, H730mm

BASIN WITH PEDESTAL

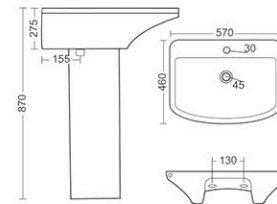

▲ BASIN WITH PEDESTAL

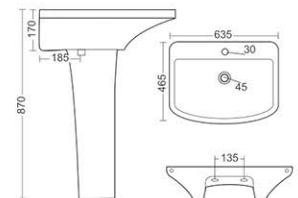

**BASIN - 729**  
L635, W465, H170mm

**PED - 730**  
L170, W225, H730mm

BASIN WITH PEDESTAL







**BASIN - 731**  
L510, W410, H150mm

**PED - 732**  
L155, W165, H705mm

BASIN WITH PEDESTAL

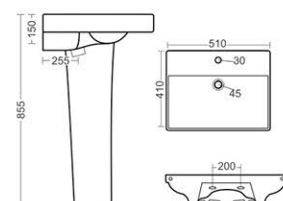

**BASIN - 731**  
L510, W410, H150mm

**PED - 786**  
L170, W235, H330mm

BASIN WITH HALF PEDESTAL

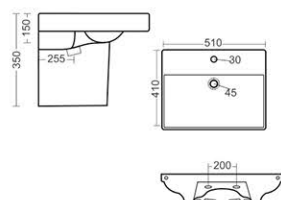

**BASIN - 741**  
L510, W410, H210mm

**PED - 742**  
L210, W200, H680mm

BASIN WITH PEDESTAL

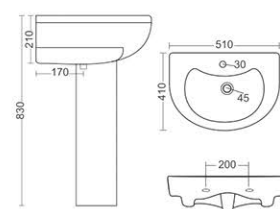

**BASIN - 741**  
L510, W410, H210mm

**PED - 766**  
L280, W210, H360mm

BASIN WITH HALF PEDESTAL

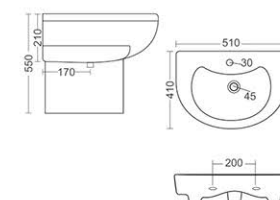

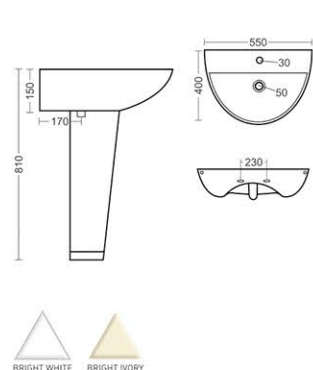

**BASIN - 711**  
L550, W400, H495mm

**PED - 742**  
L210, W200, H680mm

BASIN WITH PEDESTAL



INDO WESTERN

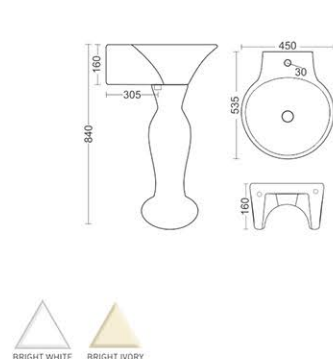

**BASIN - 773**  
L535, W450, H160mm

**PED - 774**  
L310, W310, H690mm

BASIN WITH PEDESTAL

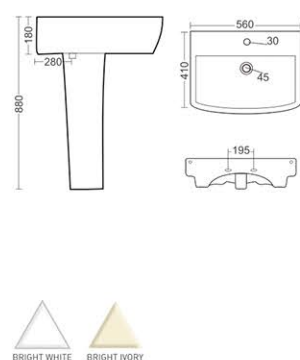

**BASIN - 743**  
L560, W410, H180mm

**PED - 732**  
L155, W165, H705mm

BASIN WITH PEDESTAL



**BASIN - 711**  
L560, W400, H495mm

**PED - 766**  
L280, W210, H360mm

BASIN WITH HALF PEDESTAL

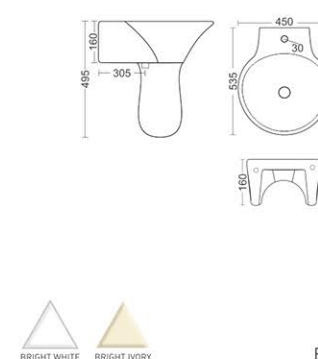

**BASIN - 773**  
L535, W450, H160mm

**PED - 775**  
L180, W180, H330mm

BASIN WITH HALF PEDESTAL

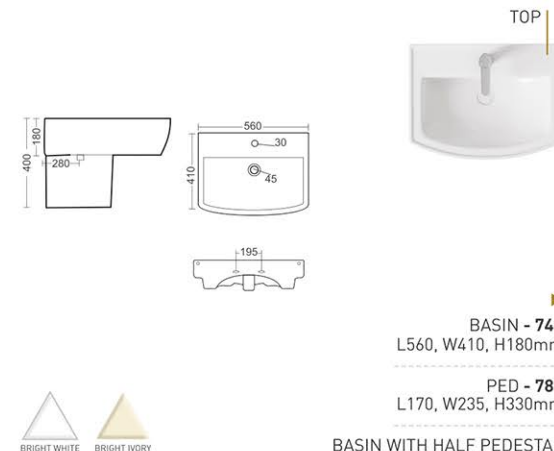

**BASIN - 743**  
L560, W410, H180mm

**PED - 786**  
L170, W235, H330mm

BASIN WITH HALF PEDESTAL



BASIN WITH PEDESTAL





**BASIN - 702**  
L560, W410, H170mm

**PED - 725**  
L160, W215, H690mm

BASIN WITH PEDESTAL

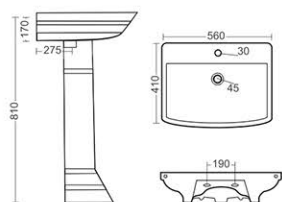

BASIN WITH PEDESTAL

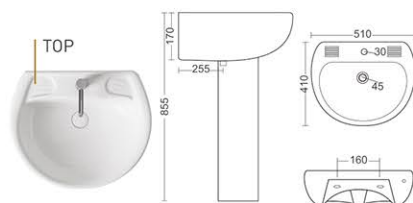

**BASIN - 797**  
L510, W410, H170mm

**PED - 798**  
L150, W185, H690mm

BASIN WITH PEDESTAL

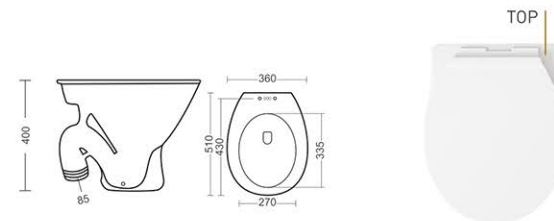

TOP

**762**

INDO WESTERN (EWC)  
S-TRAP

L510, W360, H400mm



INDO WESTERN



TOP

**763**

INDO WESTERN (EWC)  
P-TRAP

L510, W360, H400mm

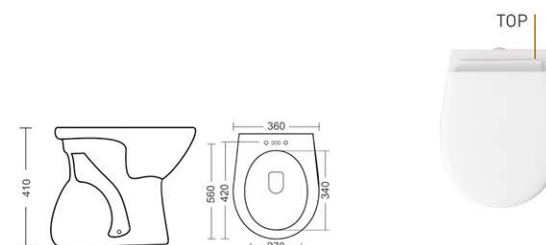
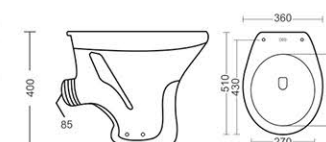

TOP

**764**

INDO WESTERN (EWC)

L560, W360, H410mm



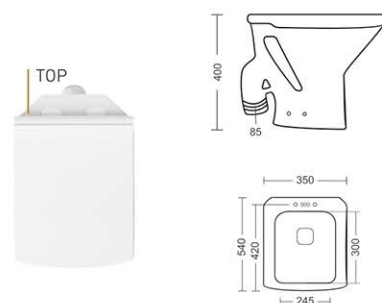

778

INDO WESTERN (EWC)

L540, W350, H400mm



781

ANGLO INDIAN  
P-TRAP

L510, W470, H380mm

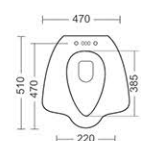

Curvy And  
**Soft Shapes** Meet  
The Priceless Design



709

ANGLO INDIAN  
S-TRAP

L510, W470, H380mm





ORISSA PAN

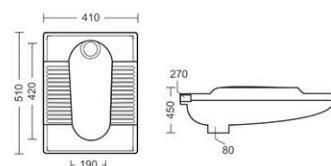

715

ORISSA PAN

L510, W410, H450mm

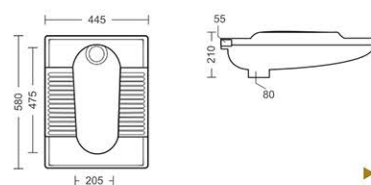

789

CITY PAN 23"

L580, W445, H210mm

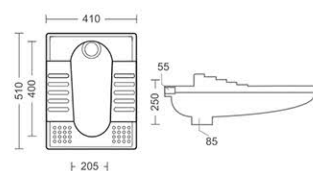

796

ORISSA PAN

L510, W410, H250mm

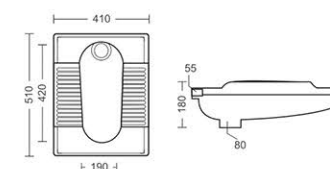

788

CITY PAN 20"

L510, W410, H180mm

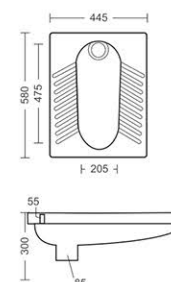

716

ORISSA PAN

L580, W445, H300mm



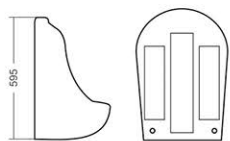

708

URINAL

L370, W380, H595mm

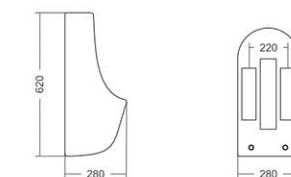

799

URINAL

L280, W290, H620mm



721

URINAL

L310, W310, H510mm

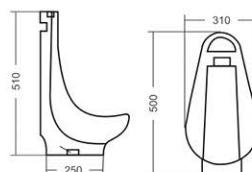

777

URINAL

L360, W310, H520mm

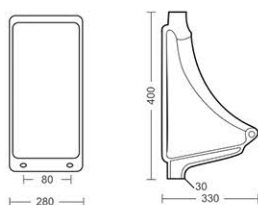
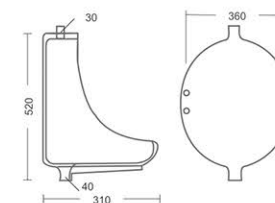

735

URINAL

L280, W330, H400mm

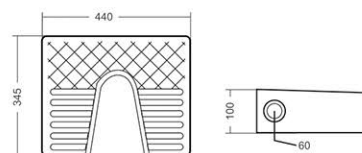

787

LADIES URINAL

L440, W345, H110mm





LAYING INSTRUCTION

WALL HUNG BASIN

As Per Shown In The Picture, The Rag Bolt Must Be Crouted Into The Cement/Concrete Wall. The Bolts Must Be Fixed To The Cement/Concrete Wall. Allow Seltng & Checking Than install It Using Nut And Washer.

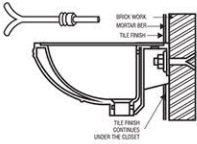

COUNTER WASHBASIN

- At The Beginning
1. A Skilled Or Experienced Person Should Install Counter Lavatories.
  2. Avoid Using Adhesive With This Product.
  3. Check The Waste Area And Supply Tubing If Required.
  4. Do Not Open The Lavatory From Its Protective Carton Until You Are Ready For Installation.
  5. Please Follow All Local Building And Plumbing Codes.

MATERIAL & TOOLS

Measure Tape, Keyhole Or Saber Saw, Hammer, Glasses, Rags Or Paper Toweling, Drill (1/2 Dia, Drill Or larger), Pencil, Sealant, Sealant, Sharp Knife Or Scissors.

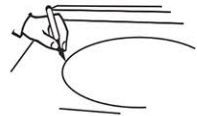

INSTALLATION OF LAVATORY

- Please Note : Please Install It In A Way That Future Removal From Underneath The Counter Top Is Possible Without Damaging The Counter Top.
1. Please Check The Desired Location For Clearance Between The Back Splash, Faucet, Fixture And Cabinet.
  2. Please Cut The Template.
  3. Please Carefully Trace The Template on The Counter Top Directed.
  4. Please Mark The Faucet Hole Centerline On The Counter Top.
  5. Please Drill A 1/2" Pilot On The Inside Of The Cut Line.

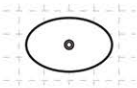

FOR WOOD COUNTER TOPS:

1. Mark And Per-Drill The Wood Screw Holes At The Locations Shown On The Template.
2. Waterproof Any Exposed Areas Of Wood.

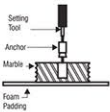

FOR MARBLE COUNTER TOPS:

1. Position The Counter Top Upside Down On Foam padding To Protest The Surface. Mark And Drill 3/6" Holes 5/8" Deep At The Locations Shown On The Template.
2. Use A Setting Tool And Hammer To Secure The Anchors.



FOR ALL INSTALLATIONS:

1. If The Counter Top Has Not Been Installed, Install It At This Time.
2. Drill The Faucet Holes According To The Faucet Installation Instructions.
3. Install The Faucet To The Counter Top According To The Manufacture's Instructions.
4. Install The Drain To The Lavatory According To The Manufacture's Instructions.

MAINTENANCE

Like Any Other Part Of Your House, The Bathroom Can be Made To Look Great And Made To Last Taken Care Of Regularly. To Make Your Bathroom Beautiful Here Are Some Invaluable Tips.



WASH BASIN

A Mild Detergent Can be Used To Wash The Basin At Least once A Day. After Washing, The Basin Should Be Wiped Out Clearly To Avoid Water Stains.

CLOSETS

Cleanser Like Harpic Can be Used To Clear The Closet With Soft Plastic, At Least Once A Day. To Avoid Minute Discoloring, After Flushing The Toilet Give It A Once Over With The Soft Brush. Keep The Toilet Brush Handy In A Convenient Stand Nearby. In Case Of Toilets And Basins, If There Has Been No Maintenance Sine Long Period Of Time, Water Deposits And Discoloration Can Form On The Surface Of Areas That Get Wet. In Such Cases, These Stains / Marks Can Be Removed With The Help Of A Solution Of Dilute Hydrochloric Acid. Clean With A Soft Cotton Cloth And Warm Water With Soap. Do Not Use Thinner, Dry Cleaning Liquids Or Powder Paste. Use A Liquid Cleaner At Least Twice a Week. Use Brasso Or Car Rubbing Compound And Then Polish With A Cloth To Remove Fine Scratches.

TECHNICAL SPECIFICATION

PARTICULARS	I.S.I REQUIREMENTS	NEXGEN VALUE
WATER ABSORPTION	<0.5%	<0.25%
MODULUS OF RUPTURE	>600 KG/CM2	750 KG/CM2
CRAZING RESISTANCE (STEAM PRESSURE OF 3.7 KG/CM2 FOR 4 HRS)	NO CRAZINGUPTO TWO CYCLES	NO CRAZING UP TO FOUR CYCLES
MINIMUM FIRED THICKNESS	SHOULD BE 6.0MM AT ANY AREA	>7MM AT ANY AREA
WARPAGE	APPLIANCE SHOULD NOT EXCEED SPECIFIED LIMIT	WELL WITHIN IN PERMISSIBLE RANGE
THICKNESS OF GLAZE AT ANY PLACE	NOT SPECIFIED	400 MICRONS (0.4 MM)
SURFACE QUALITY	NOWAVY FINISH ON VISIBLE SURFACE	NO WAVY APPEARANCE
DISCOLOURATION	NONE ON VISBLE SURFACE	NONE
RESISTANCE TO CHEMICALS	SHOULD RESISTANT TO ALL HOUSEHOLD CHEMICALS	PASSES
RESISTANCE TO STAINS AND BURNS	NO STAIN SHOULD REMAIN ON TESTING	PASSES

TROUBLE SHOOTING GUIDE

ITEM	PROBLEM	PROBABLE REASONS	CORRECTIVE ACTIONS
One piece Closet	1. Water not coming in bowl area while flushing	Water line not cleaned properly	Before installation clean the incoming as well as outgoing line
		Malfunctioning of Mechanism inside tank	Change the mechanism
		No water flush tank	Raise the height change slot to the max. level
	2. Leaking of water in bowl area	Push button is locked	Release the push button
		Fitment of mechanism end part and outlet of tank not fitted properly	After opening the mechanism check the fittment
		Malfunctioning of Mechanism inside tank	Change the mechanism
Wall hung water closet	3.Insufficient water quantity for effective flushing.	Height change slot adjusted at lower level.	Closet is not leveled properly
	4.Uneven flow of water from both side of closet	Raise the height change slot to the max. level	Level the closet properly
	1.Water not coming in bowl area while flushing	Flush valve / concealed cistern is not working properly	Change flush valve / concealed cistern
		Flush pipe is not inserted up the end of inlet hole.	Insert the flush pipe upto the end of inlet
	2. Leaking of water in bowl area	Closet is not leveled	Level the closet properly
Wash basin / Table top	3. Insufficient water quantity for effective flushing.	Connection between closet outlet and drainage pipe is improper.	Engage experienced plumber for proper connection
	1.Overflow chocked and foul smell	Full threaded waste coupling might be in use.	Replace it by slot cut coupling
	2.Water logging in platform and bowl area	Bracket and basin fixing may be the reason	Leveling to be checked and rectified
	3.No tap hole in the basin	Tap hole is semi punched from back side	Call plumber and open up the semi punched hole.
EWC/Pan/ Anglo Indian	1. Water not coming in bowl area while flushing	Flush bend is not inserted up to the end of inlet hole	Insert the flush pipe upto the end of inlet
		Leveling issue	To be leveled properly

[illegible]